

Temperature Management Controller



The Time is Now.



The WC77 Multiport Controller provides maximum versatility and efficiency to patient temperature management, and brings the HotDog Patient Warming System to the forefront of advanced, patient-centered care.

- 7-inch Touchscreen with Intuitive User Interface
- Temperature Monitoring*
- Auto Mode*
- Control Multiple Devices at Once
- Integrated Slide Shows
- Positioning Guides
- Adjustable Settings (Volume, Brightness, Auto Shutoff Timer, and more...)
- Troubleshooting Information Available
- Integrated Self Test



There's never been a better time to go Air-free.

Reliable patient warming at your fingertips. Control all devices at once or individually by touch.



Temperature Monitoring & Auto Mode*

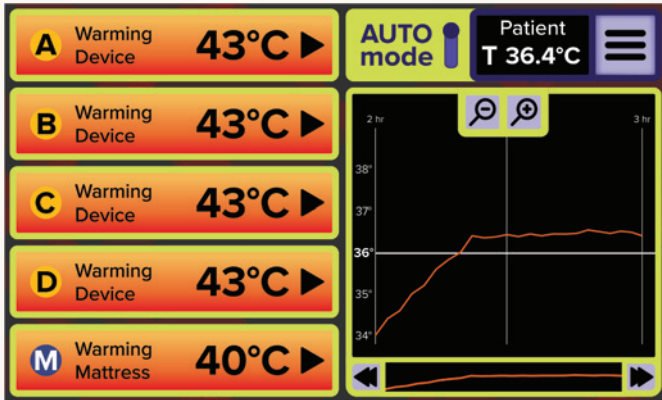

Temperature monitoring allows automatic control of the warming devices based on the patient's temperature. (*CE Marked and Pending FDA Clearance)

Integrated Training Slideshows



Controllers come loaded with slideshows to help you get started and learn the BEST Practices.

Adjustable Settings

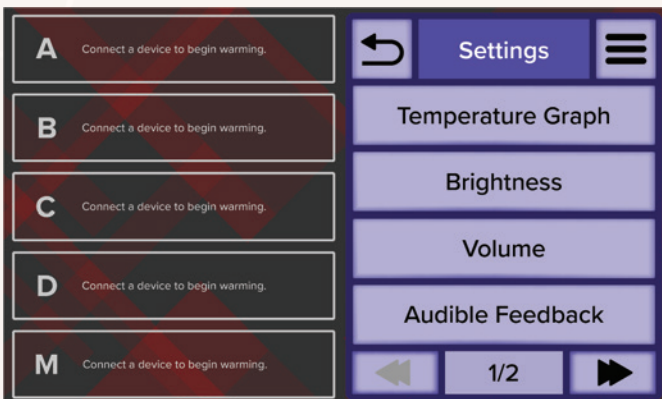

Too loud, too quiet? Too bright, too dark? Change various settings such as volume, brightness, language, shutoff timer, and more.

Positioning Guides

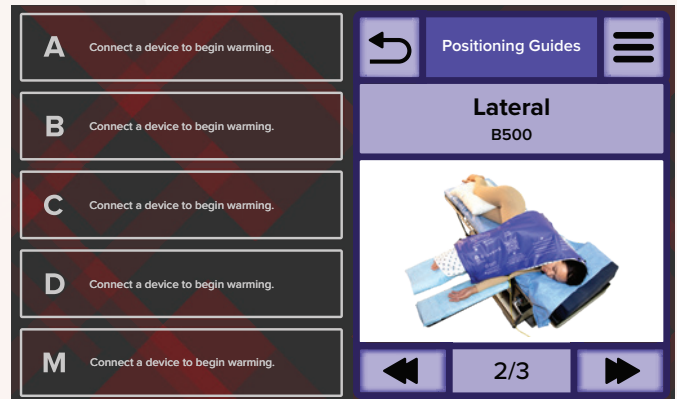

Blanket placement guides for various surgical positions are included to help you begin your procedures faster.